

DEPARTS FROM ARMSTRONG

STRIKER'S POINT LODGE

At the eastern end of Whitewater Lake is Striker's Point, one of our full-service lodges, deep in the heart of Wabakimi Provincial Park. Striker's Point is a haven for anglers. With 26,000 acres of water to explore, it's the perfect haven for those in search of trophy pike and prolific walleye.

Striker's five cozy, vertical log cabins feature a full sized fridge, full bathroom and a comfortable sitting area with couches and a woodstove. The spacious dining area, lounge and gift shop are only a short walk away in the main lodge. Down at the dock, your boat and motor await ready to head on the water.

Whether you're a couple, a bunch of friends, or a larger group, we can accommodate up to 24 people at one time. Come and experience this world-class fishery in style at Striker's Point Lodge

TRIP HIGHLIGHTS

INCLUDED ITEMS

- Flights from Armstrong to the lodge
- Shore lunch or box lunch prepared daily
- Breakfast and 3-course dinner served daily at the main lodge
- Pre-dinner cocktail reception with appetizers and complimentary drinks
- Main lodge with TV and free Wi-Fi internet
- 24hr electricity
- Bar fridge in cabin
- Daily housekeeping service
- Dock and fish cleaning services
- 16ft Lund boats with 25hp Yamaha 4-stroke electric start motors (padded swivel seats, minnow buckets, depth finders, anchors, landing nets, life jackets, safety kits, and gas included)



WHITewater LAKE STATS

- Latitude: 50 47.3 North
- Longitude: 89 21.9 West
- Length: 26 miles or an area of 26,000 acres
- Avg Depth: 25 feet
- Water Clarity: dark tea-stained water
- Easy access to Ogoki River, Walleye, Northern Pike, & Lake Trout

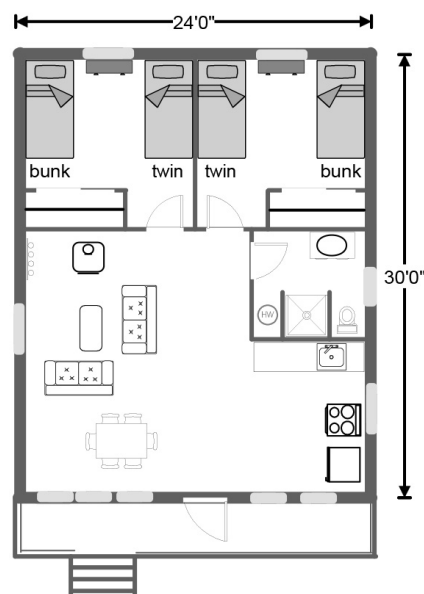

WHITEWATER LAKE

